

1. GENERAL

Bellows end seals for sealing the gap between the main pipe and the jacket pipe at the ends of crossing

Range

ID casing [mm]	DE pipe [mm]
50 - 900	100 -1050

2. INSTALLATION

Prior to installing carrier pipe into casing slide End Seal loosely onto carrier pipe (insertion side) making sure to have large size of end seal facing toward casing pipe.

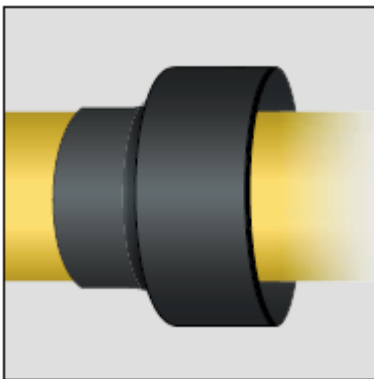

Insert the end seal on the main pipe before inserting the casing pipe otherwise the final connection of the pipeline.

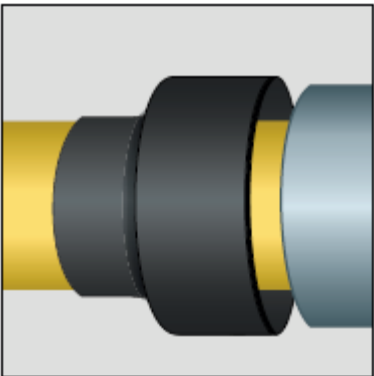

Insert the end seal on the jacket pipe

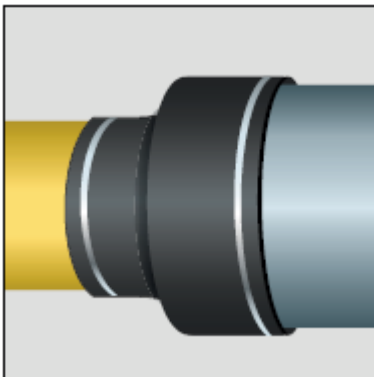

Secure both pipes with the supplied straps.